

55, Red Lodge Road, Bexley DA5 2JP  
Guide Price £475,000



Guide Price £475,000-£500,000 A deceptively spacious three/four-bedroom semi-detached chalet bungalow, beautifully refurbished throughout to provide stylish, contemporary living. Perfect for families, the property enjoys a convenient position close to sought-after local schools, a range of shops and excellent transport links. The ground floor features an inviting entrance hall, a modern fitted kitchen, a generous reception room, a luxury bathroom and two well-proportioned bedrooms. Upstairs, the first floor offers a sleek wet room and two additional bedrooms, ideal for flexible use. Further benefits include double glazing, gas central heating, air conditioning, elegant herringbone flooring, a garage and a thoughtfully landscaped rear garden. Early viewing is strongly advised.

Local Authority:  
Council Tax Band: D



**01322 553322**

60-62 High Street, Bexley, Kent DA5 1AH

bexley@parkestates.co.uk  
www.parkestates.co.uk

## Red Lodge Road

Approximate Gross Internal Area = 95.5 sq m / 1028 sq ft  
(Excluding Eaves)

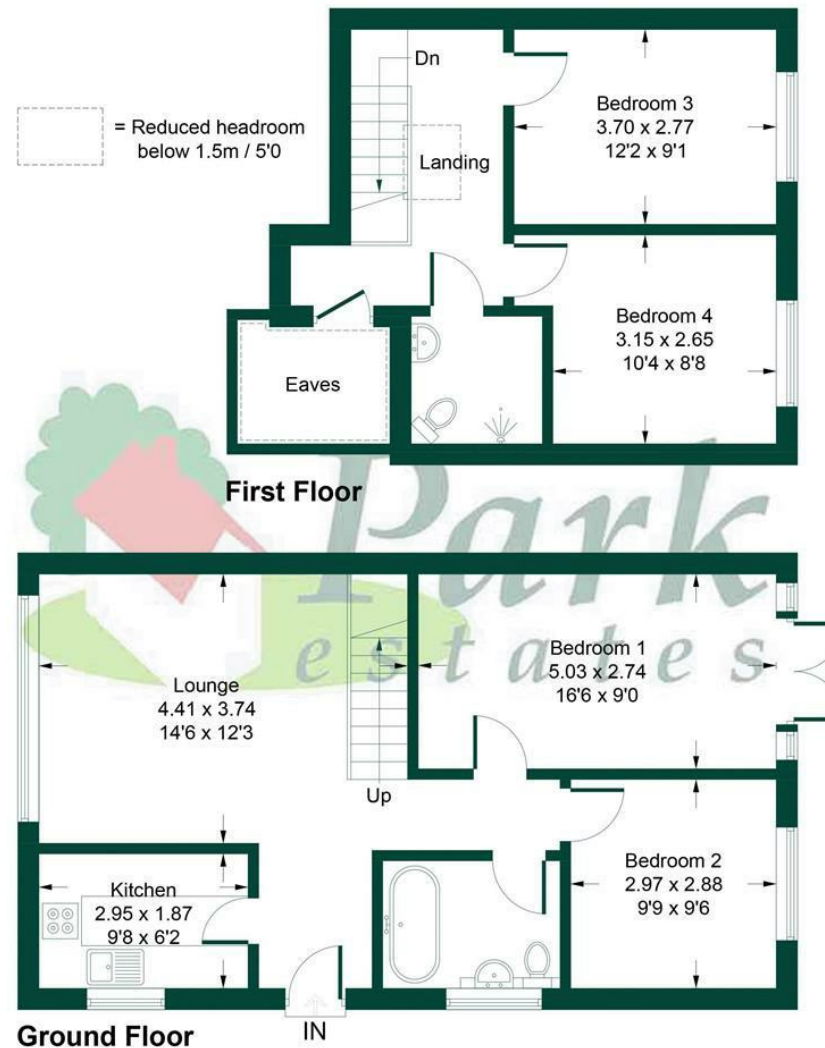

This plan is for layout guidance only. Not drawn to scale unless stated. Windows and door openings are approximate. Whilst every care is taken in the preparation of this plan, please check all dimensions, shapes and compass bearings before making any decisions reliant upon them. Produced by Planpix on behalf of Park Estates (ID837304)

Every care has been taken with the preparation of details, but accuracy is in no way guaranteed. These particulars do not constitute a contract and are issued and accepted on the express understanding that all negotiations will be conducted through Park Estates. The seller does not make or give, nor do we or our employees have any authority to give a representation or warranty in relation to the property. Please contact this office before viewing the property. If there is any point which is of particular importance to you, we will be pleased to check the information for you and confirm that the property remains available. This is particularly important if you are contemplating travelling some distance to view the property. We would strongly recommend that all the information that we provide about the property is verified by yourself on inspection and also by your conveyancer, especially where statements have been made by us to the effect that the information provided by us has not been verified.